

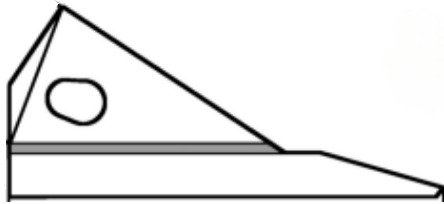

H&L STYLE PROFILE GUIDE

FABRICATED

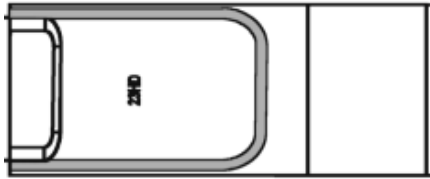

STANDARD

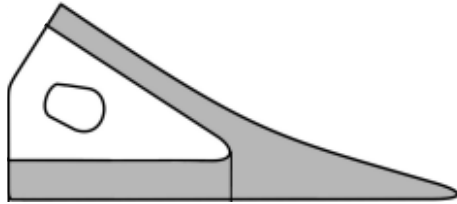

STAR

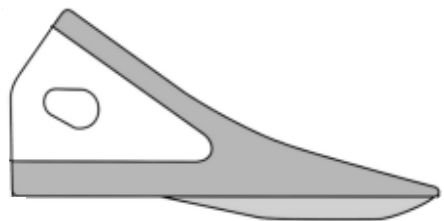
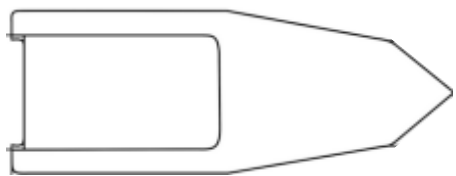

FLARE

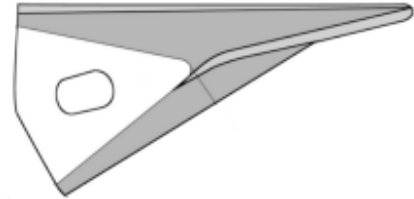
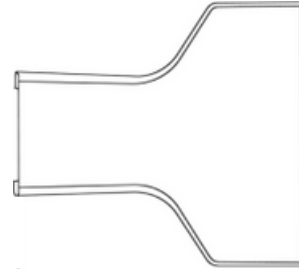

SINGLE TIGER

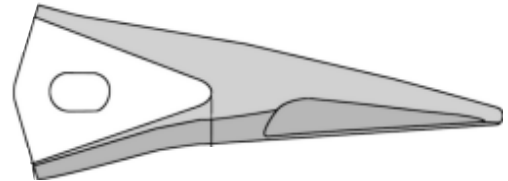

TWIN TIGER

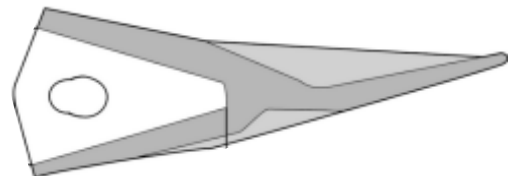
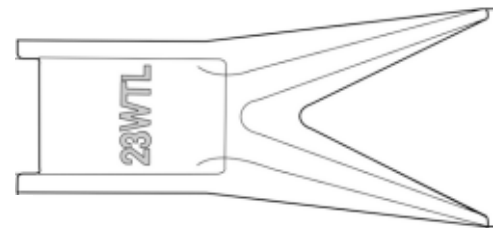

230 TEETH

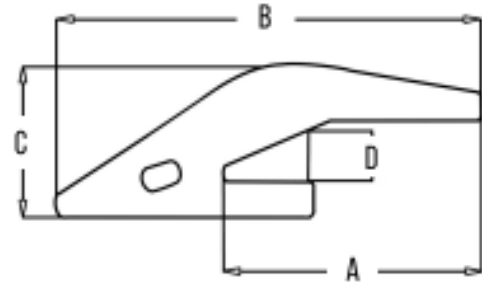
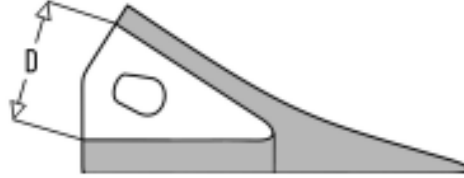

Part No.	Description	Weight	A	B	C	D
23HD	tooth, fabricated	2.2 (4.85)	5.5 (140)	2.22 (56.4)	1.54 (39.1)	1.85 (47)
230SP	tooth	2.8 (6.17)	5.78 (147)	2.20 (56)	1.54 (39.1)	2.39 (60.6)
230ST	star tooth	3.6 (61)	6.12 (155.6)	2.4 (62)	1.54 (39.1)	2.39 (60.7)
23TL	tiger long tooth	2.4 (52.9)	6.44 (164)		1.54 (39.2)	3.13 (80)
23THD	tiger heavy duty tooth	2.8 (6.17)	6.44 (164)		1.54 (39.2)	3.13 (80)
23WTL	twin tiger long tooth	2.6 (5.73)	6.44 (163)	3.00 (76)	1.56 (40)	1.69 (43)
23W	flare tooth	3.4 (7.50)	5.25 (133.4)	4.75 (120.6)	1.57 (40)	2.5 (63.4)
2740-MW-23	adapter, weld-on 3/4"	4.3 (9.48)	6 (152.4)	9.43 (239.52)	2.9 (73.66)	1.19 (30.23)
U43792	adapter, weld-on 1"	3 (6.61)	4.62 (117.5)	7.46 (189.7)	2.43 (61.7)	1 (25.4)
2300FL	adapter flush mount weld-on	4 (8.18)	4.65 (118.2)	7.9 (200.7)	2.42 (61.4)	
23P	flex pin	0.1	2.13 (54.14)	.73 (18.78)		
TF23P	flex pin, long	0.1	2.17 (55.2)	0.77 (19.46)		

240 TEETH

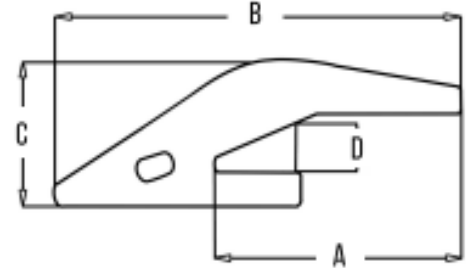
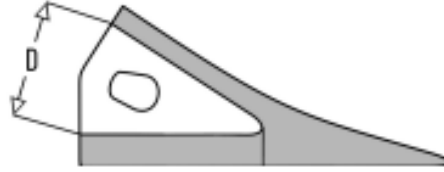

Part No.	Description	Weight	A	B	C	D
24HD	fabricated tooth	3.52 (7.76)	6.44 (163)	2.4 (61)	1.5 (38)	2.39 (60.6)
240	tooth	4 (8.81)	7.25 (184.15)	2.27 (57.65)	1.56 (39.62)	3.1 (78.74)
240F	flare tooth	6.69 (14.77)	4 (102)	1.56 (40)	2.13 (54)	4.13 (105)
240010	adapter, weld-on 1"	5.5 (12.13)	5.5 (139.7)	10.14 (257.8)	2.87 (72.9)	1.05 (26.9)
24P	flex pin	0.1	2.04 (51.85)	0.88 (22.45)		

250 TEETH

Part No.	Description	Weight	A	B	C	D
250	tooth	6.6 (14.55)	7.63 (193.88)	2.87 (72.89)	2.22 (56.39)	3.08 (78.23)
250TW	twin tiger long tooth	6.3 (13.89)	8.0 (203)	2.06 (52)	2.19 (56)	4.13 (105)
2500-125	adapter, weld-on 1.25" (2740W25)	7.8 (17.19)	10 (254)	15.12 (384.1)	3.25 (82.6)	1.59 (40.4)
25P	flex pin	0.1	2.75 (71)	0.83 (21.1)		